

**PUSH**

**DIN Right**

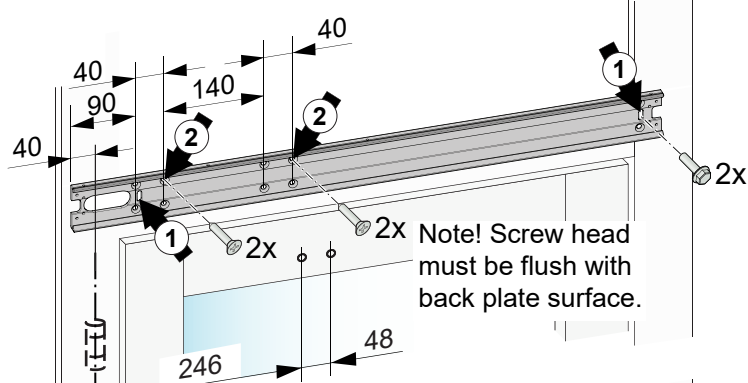

SW300-S, Size 7 PUSH-335

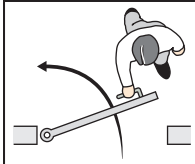

<https://s3m.io/OTjIE>

**5** Default setting for PUSH

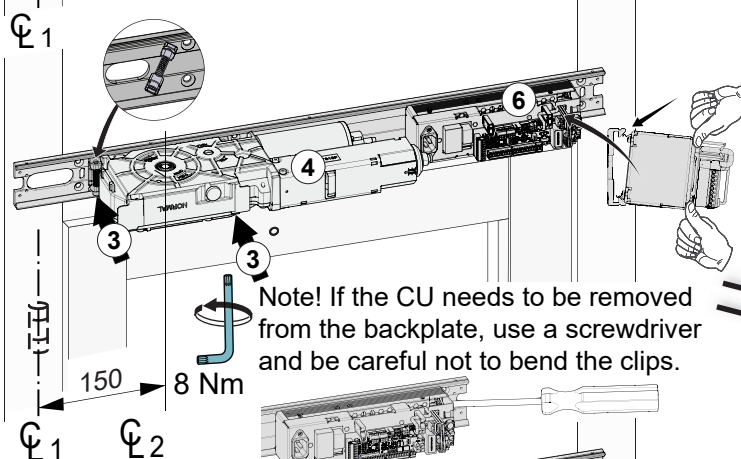
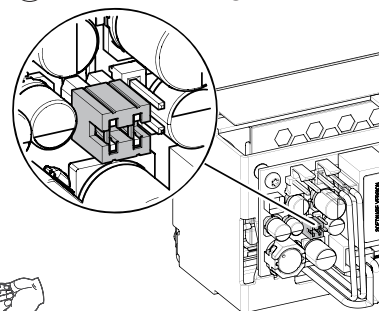

Spring pretension  $\approx 20^\circ$

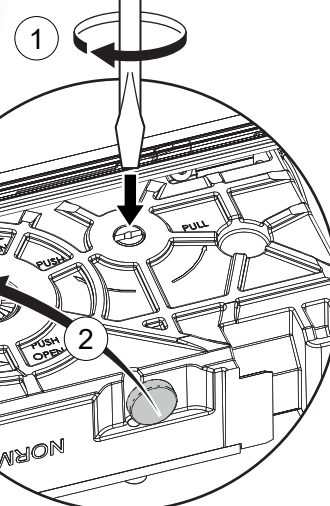

**Quick Start**

**ASSA ABLOY SW300-S**



1023408

**ASSA ABLOY**

3.0

1023430-en

Align the arm with the operator mark.

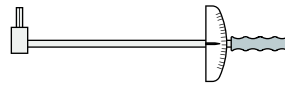
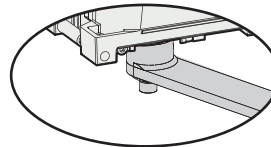
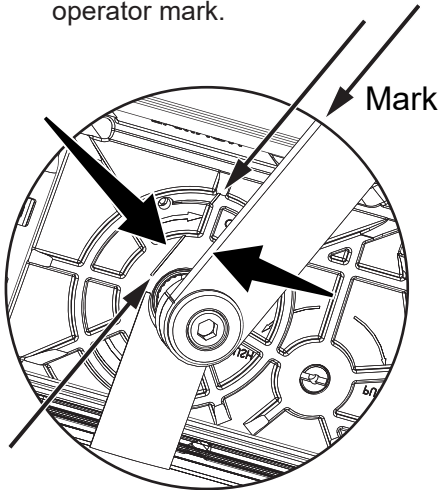

Tighten the screw temporarily to keep the arm in place.

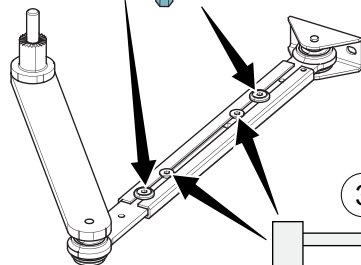
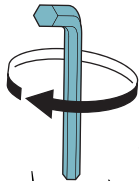
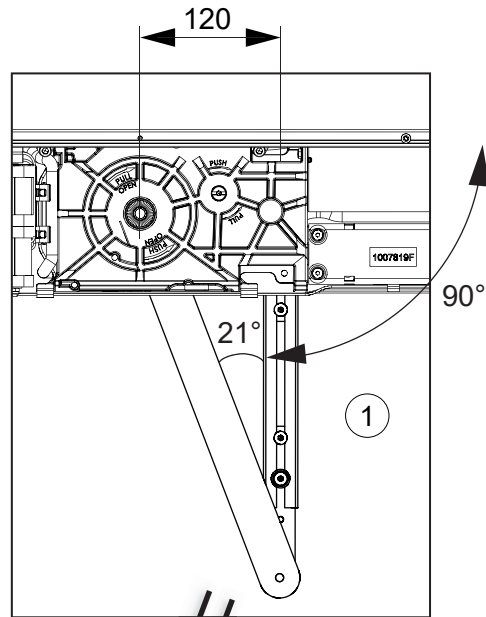
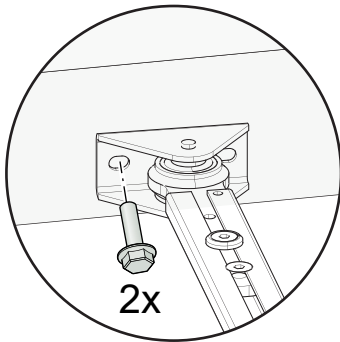

10 lbf·ft (14 Nm)

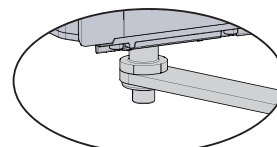
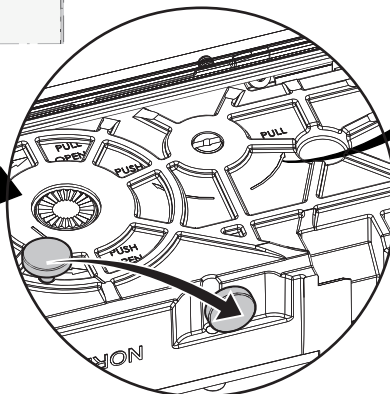
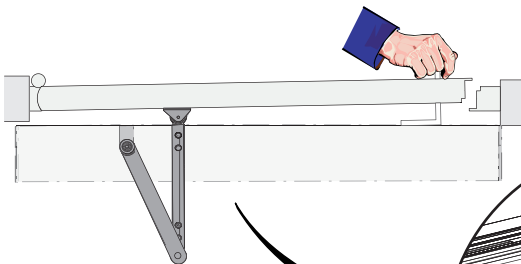
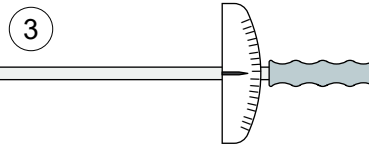

50 Nm

Note! Important to make sure you tighten with 50 Nm before completing the mechanical installation!



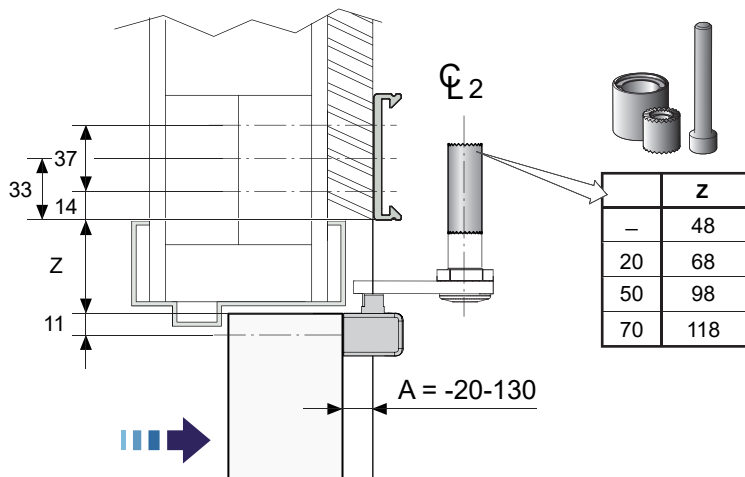

**PULL**

**DIN Right**

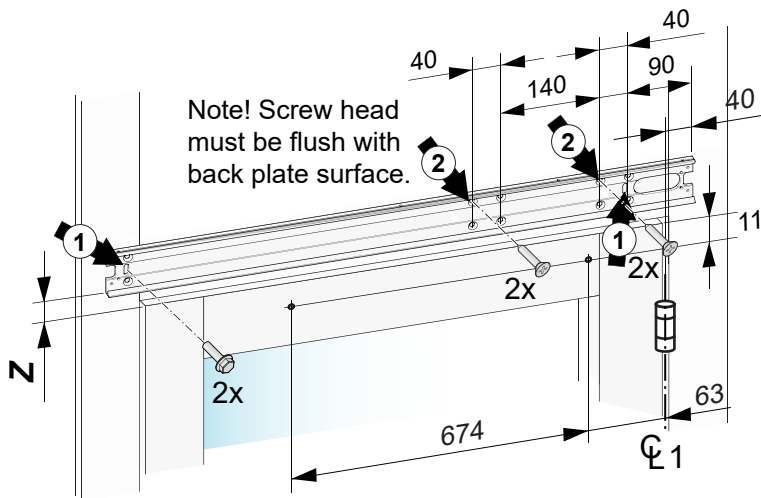
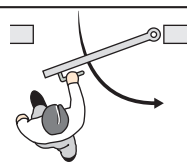

SW300-S, Size 6 PULL-400



<https://s3m.io/zj2Gi>

⑤ Change setting for PULL

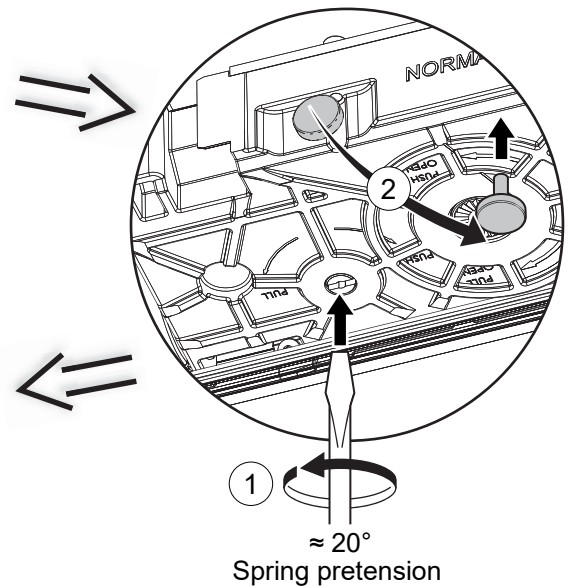
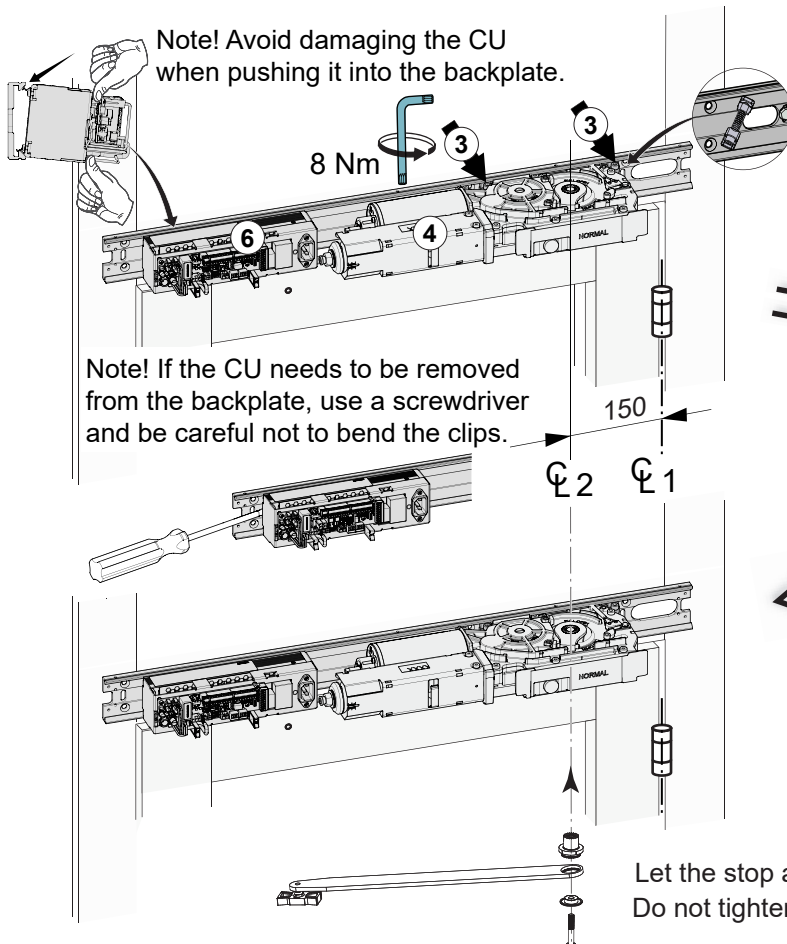
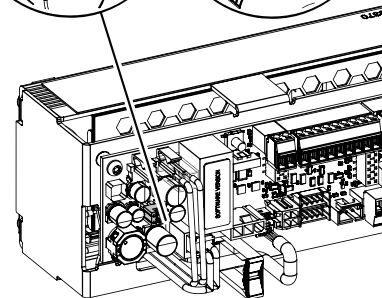
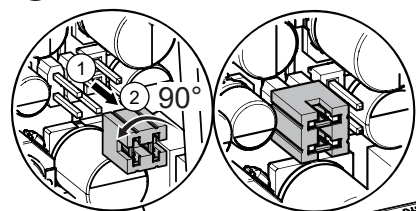

Let the stop arm locator and the stop arm be loose. Do not tighten.



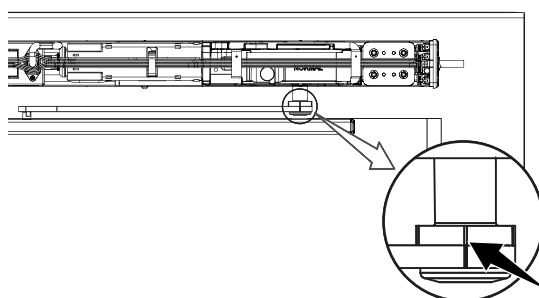
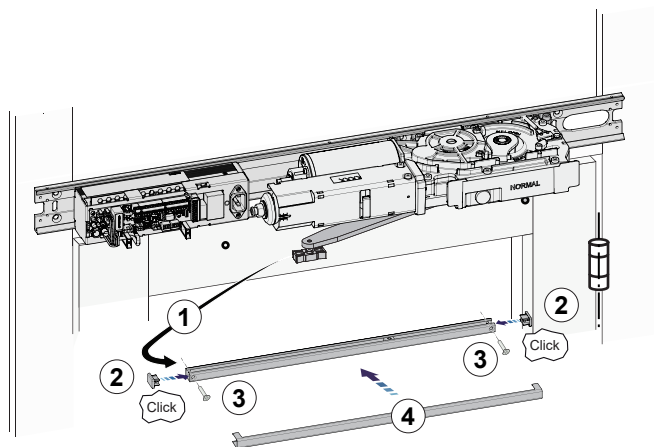

It is important to align the marks correctly.  
If necessary move one mark at a time.  
This is equivalent to approximately  $3^\circ$ , with a precision of  $\pm 1.5^\circ$ .

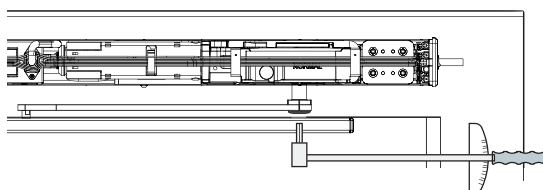

Tighten the screw temporarily to keep the arm in the place.

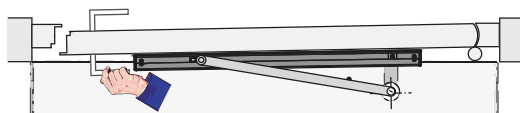

1

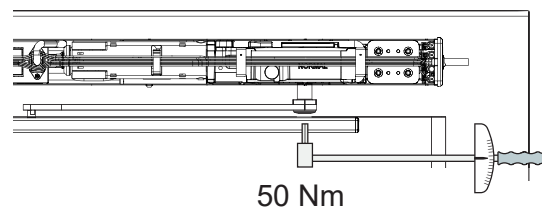
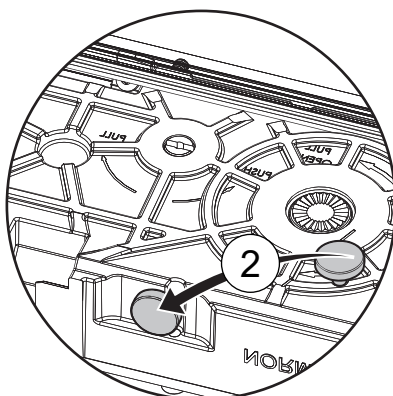

50 Nm

Note! Important to make sure you tighten with 50 Nm  
before completing the mechanical installation!



Cables

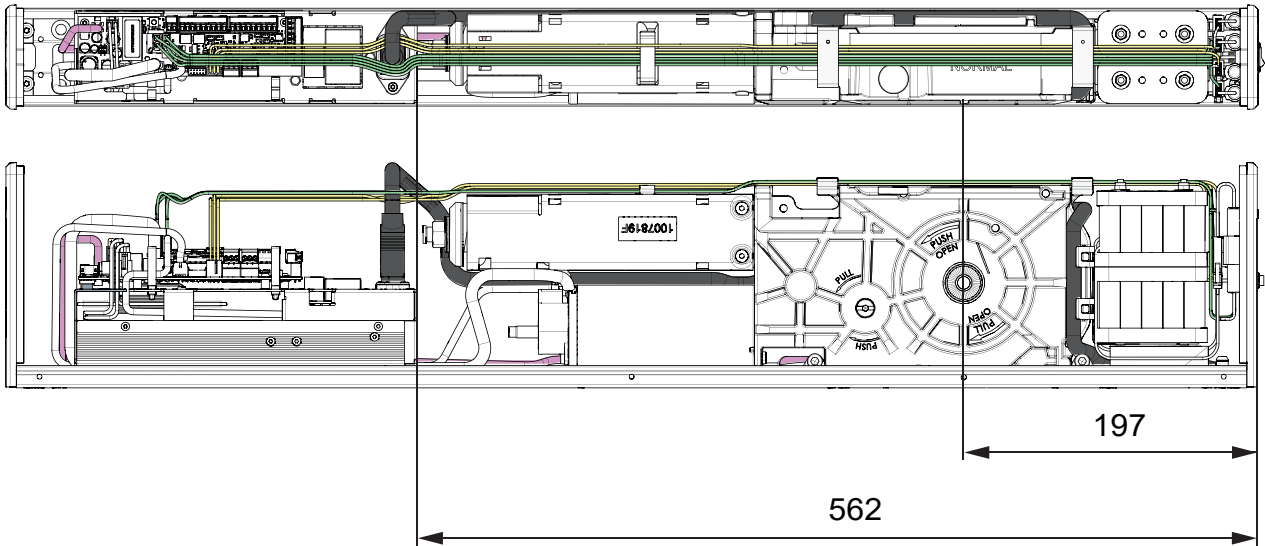
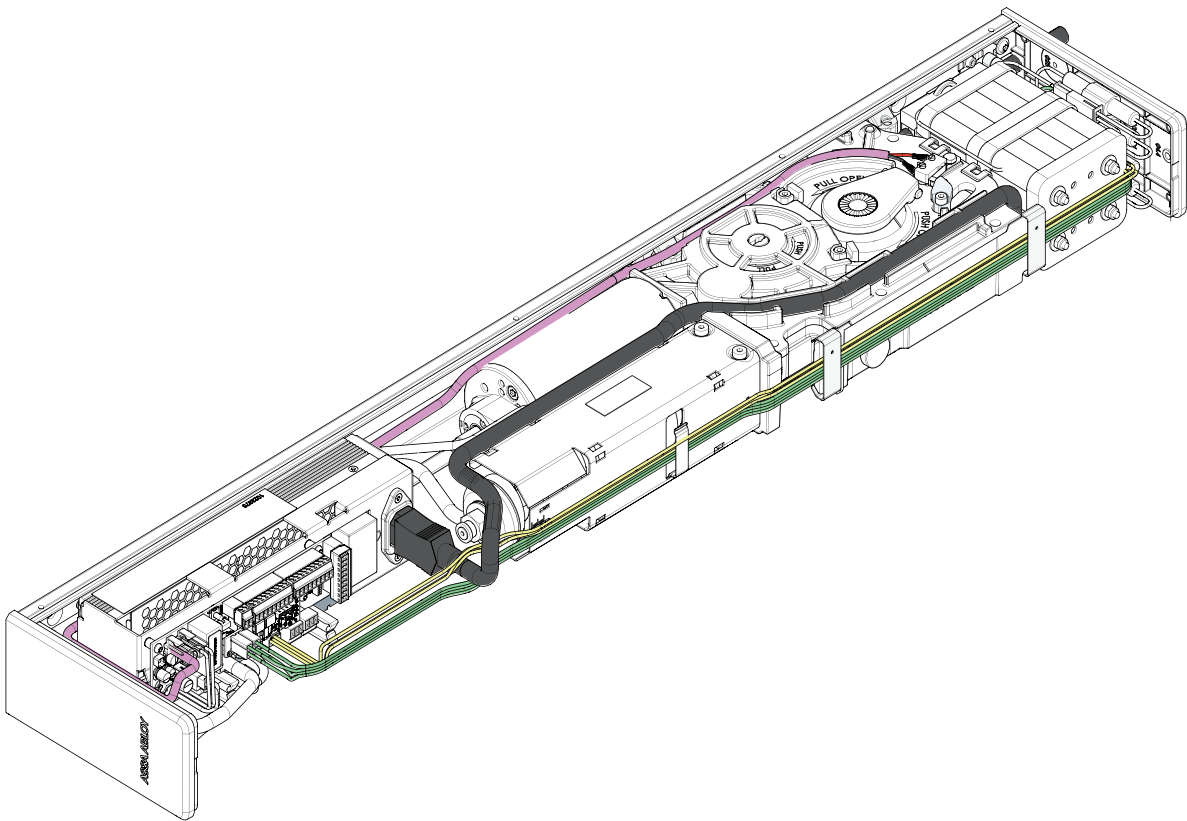

## Spring Pre-tension

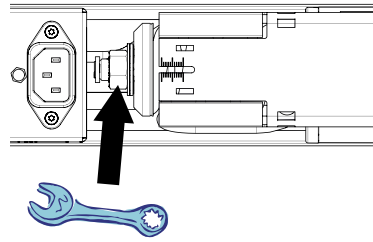
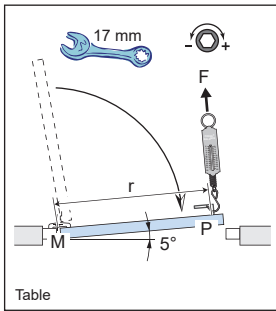

## Lock kick at power failure

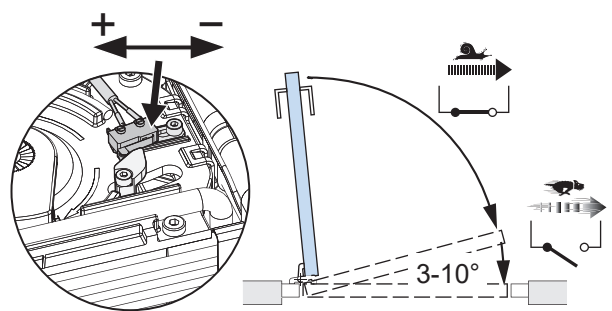

Door closer power size according to EN1154	Recommended door leaf width mm max.	Closing torque between 0° and 4°		Opening torque Between 0° and 60° Nm max.*
		Nm min.	Nm max. <	
4	1100	26	37	62
5	1250	37	54	83
6	1400	54	87	134
7	1600	87	140	215

Measured with spring balance at point (P)  
10 N ≈ 1 kg

Distance (r) from hinge to measuring point P	Closing force (F) between 0° and 4° measured at point P	
	N min.	N max. <
1050	25	35
1200	31	45
1350	40	64
1550	56	90

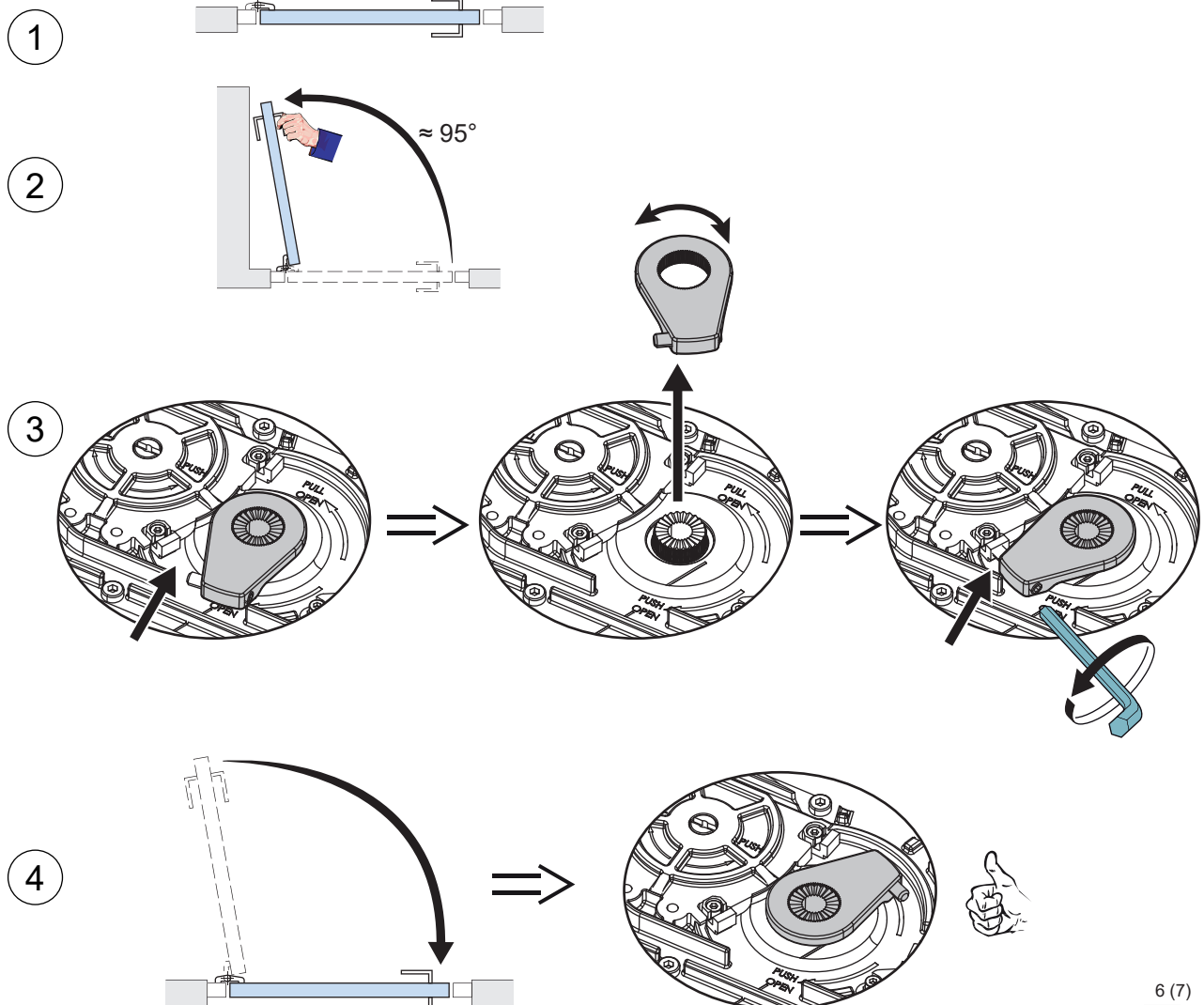

1. Start the app.
2. Select "Connect for installation" and follow the guide.
3. When prompted, press and hold the learn button (LRN) on control unit for four seconds, the app will now connect with the door operator.

**NOTICE!** When pressing learn button less than four seconds the learn will only initiate after arm system (parameter ID: 03) has been selected.

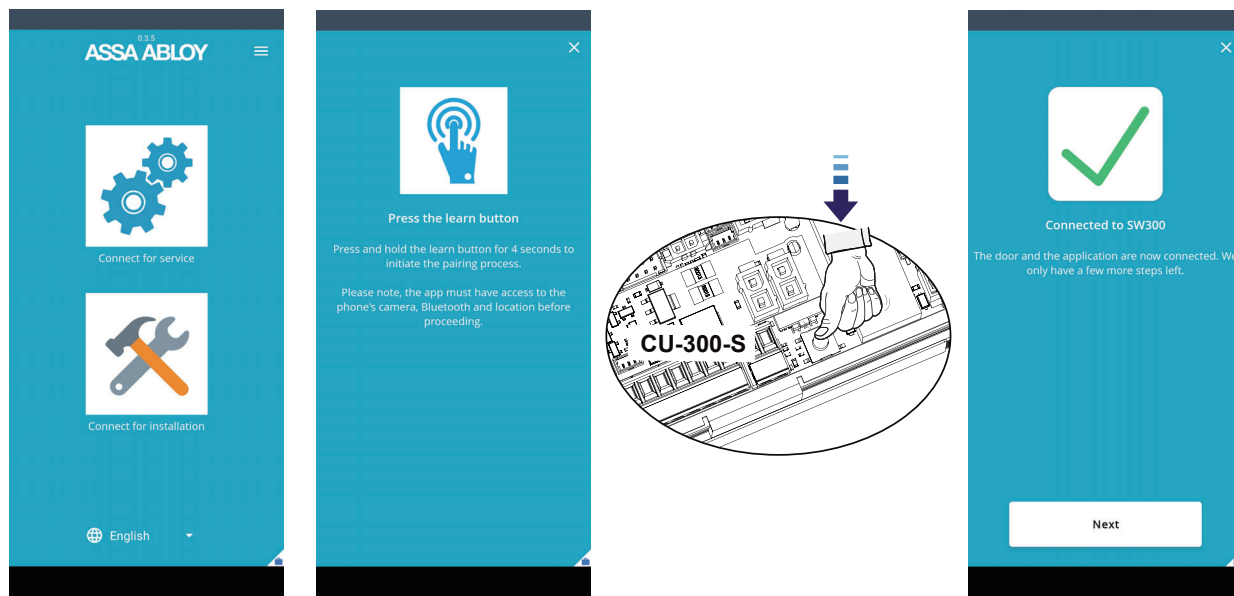

Learn can be executed by pressing the button less than one second or from the app.

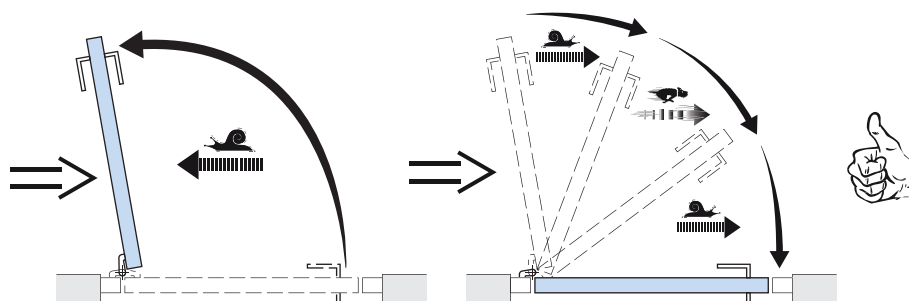

## Other applications

SW300-S, Sliding push PULL-400



<https://s3m.io/TuEfl>

SW300-S, Inverse PUSH-335



<https://s3m.io/MbSXZ>

SW300-S, Double door



<https://s3m.io/KYcUy>

SW300-S, Battery back-up unit



<https://s3m.io/DmizJ>

